



29

**QUALITY, COMFORT AND PERFORMANCE
AT A PRICE YOU CAN AFFORD**





The Watkins 29 has an exceptionally roomy interior. The headroom is over 6' 3" which coupled with the wide cabin gives the interior the feel of a much larger boat. Live aboard features like pressure water, shower and 110 volt shore power are standard on the 29. Sleeping accommodations for five are standard with an optional pull-out double for the port lounge berth.

SPECIFICATIONS

LOA	28'11"
LWL	24'0"
Beam	10'4"
Draft	4'
Displacement	8,800 lbs.
Ballast	3,900 lbs.
Sail Area	385 sq. ft.
Mast Height Above DWL	40'1"
Headroom	6'3"
Fuel Capacity	20 gal.
Water Capacity	40 gal.
Engine	15 Diesel

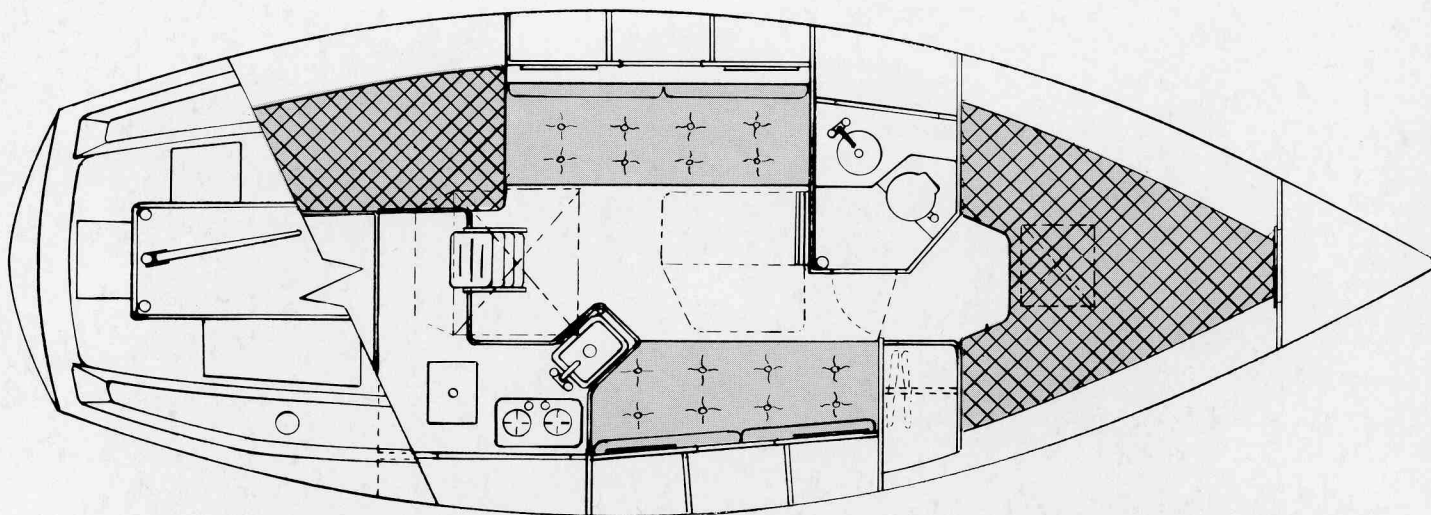



The Watkins 29 is an exceptionally strong boat with a hull constructed of solid hand laid-up fiberglass. Watkins uses a cored construction in the deck for lightweight stiffness but never in the hull. Mast, rigging, lifelines are all "next size up" for reliability.

An on deck inspection of the 29 gives an indication of the built-in quality Watkins provides. Winches, hatches, pedestal steering, spars, rigging are all top line quality names. The large anchor locker and the two-tone gel coat non-skid are other indicators of quality.

The unique external thru-bolted combination toe rail and hull to deck joint, first introduced on the

Watkins 36, is now standard on all Watkins boats. This extremely water tight connection has been copied by other manufacturers since its introduction.

Watkins boats sold into charter have been routinely sailed on their own bottoms to Puerto Rico sometimes thru heavy winds and seas with never a structural failure.

watkins 29



The Watkins 29 continues the Watkins tradition of building quality boats with roomy interiors and excellent sailing characteristics.

The 29 has many big boat features as standard equipment plus more as optional items. Reliable power is provided by the standard 15 HP diesel inboard. The huge smoked plexiglass main hatch together with eight opening ports and an aluminum framed forward hatch provide the 29 with excellent ventilation and light below.

The Watkins 29 with its fine entry forward and its long run aft points and foots with the best of them. The 29 is sure to please you sailing, cruising and living aboard.



WATKINS YACHTS, INC.

12645 49th Street North
Clearwater, Florida 33520

Telephone (813) 577-3684